

cat. no. 216.08

Personnel Airlocks

SINK CABINET

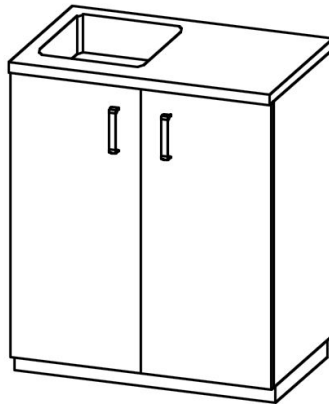

- Completes the range of facilities for personnel and material pass-through.
- Sink cabinets are available in two designs
 - door design
 - design suited for optional step-over bench

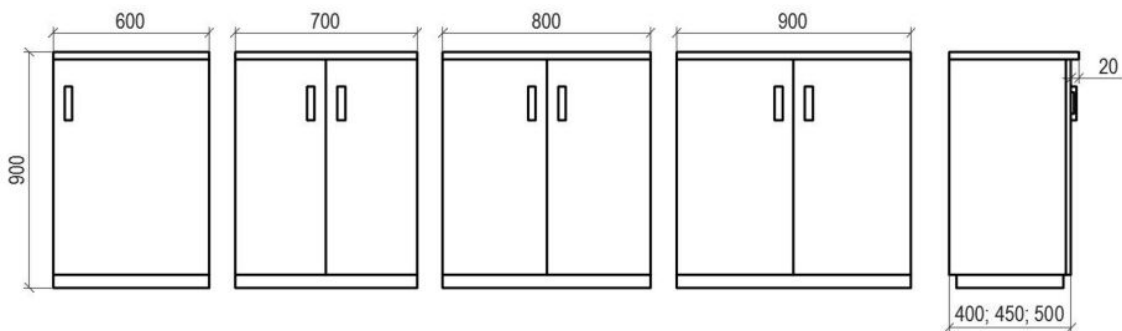

Sink cabinet for pass-through

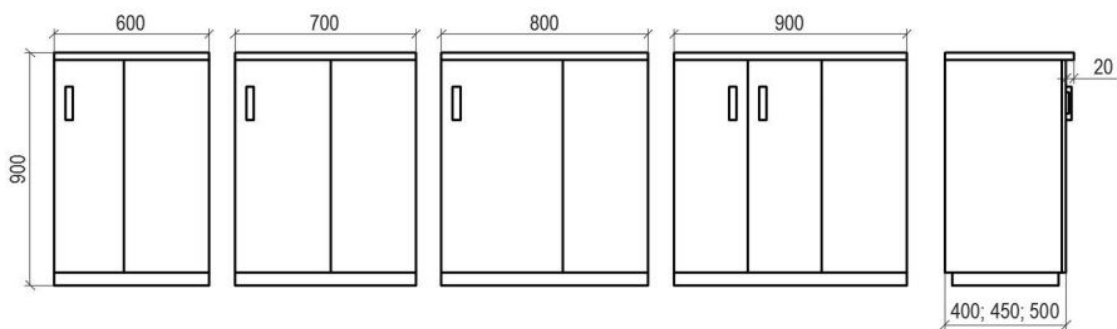

Sink cabinet for pass-through, suited for optional step-over bench

MORE INFORMATION, PHOTOS



TECHNICAL DATA

Type designation

Sink cabinet

Material design

value	Material
Standard	
Standard plus	
Premium 304	

Type design

height	value
900 mm	Sink cabinet
900 mm	Sink cabinet with a bench fitted from the left
900 mm	Sink cabinet with a bench fitted from the right
The indicated height includes the basic profile with a height of 50 mm.	

Door swing direction

Two-door cabinet
Left door
Right door

Width

width	value
600 mm	Cabinet width
700 mm	Cabinet width
800 mm	Cabinet width
900 mm	Cabinet width

Cabinet depth

value	depth
Depth	400 mm
Depth	450 mm
Depth	500 mm
The ground plan dimension of the cabinet is indicated without the worktop. With the worktop installed, the depth is larger by 20 mm.	

Plinth 50 mm

Basic profile covered with floor covering. For new floor covering
Metal profile with surface finish. For the existing floor covering

Colour finish of the cabinet

White colour
Non-standard - optional colour finish

Worktop

Stainless steel AISI 304

Postforming

Sink type

Stainless steel sink AISI 304, diameter 400 mm **

Stainless steel sink AISI 304, dimensions 400x340x200 mm

Stainless steel sink AISI 304, dimensions 330x235x180 mm *

Stainless steel sink AISI 304, dimensions 290x340x180 mm *

Stainless steel sink AISI 304, dimensions 400x290x200 mm *

Stainless steel sink AISI 304, dimensions 400x400x200 mm

Stainless steel sink AISI 304, dimensions 250x370x150 mm **

* sinks intended for stainless steel worktops

** sinks intended for post-forming worktops

Sink position in the worktop

The sink is located at the left of the cabinet

The sink is located at the right of the cabinet

The sink is located at the centre of the cabinet

Mixer-tap type

Wall-mounted mixer tap

Upright single-lever mixer

Upright single-lever mixer with pull-out spout

Upright sensor-controlled mixer

Mixer tap position

The mixer tap located left of the sink

The mixer tap located right of the sink

No hole for the mixer tap in the worktop

Worktop area

Smooth worktop *

Worktop with offset and a rear rim, height 30 mm

Worktop with offset

Smooth worktop with a rear rim, height 30 mm

* for postforming worktop

Worktop colour design

Stainless steel worktop - SB surface

Postforming worktop, white colour

Postforming worktop, grey colour

Postforming worktop, abstract colour

Non-standard design

Standard design

Non-standard solution

Standard design

0 - clear specification out of offered options

Non-standard design

Q - atypical solution that cannot be clearly specified using a code