

## Forlab - Bottom cabinets

# CABINET WITH HORIZONTAL SHIFT

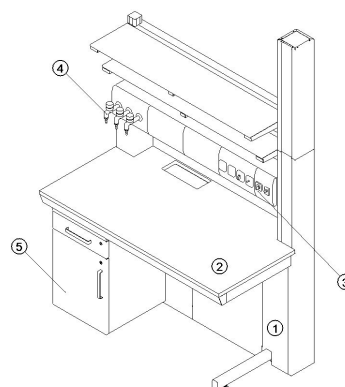
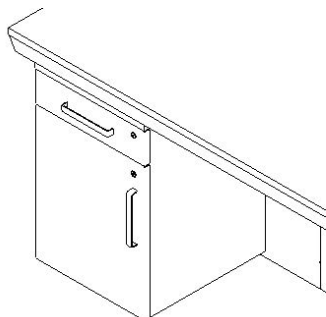

- 1 - Media panel, chapter 203.01  
 2 - Worktop, chapter 205.01  
 3 - Elektro media, chapter 207.03  
 4 - Pins gaseous and liquid media, chapter 207.03  
 5 - Cabinet with horizontal shift, chapter 204.05

- Specially designed cabinet for the metal base type „C“.
- Cabinet is suspended in the mobile system, attached to the frame of the table.
- The cabinet has no legs. Below cabined is opened space, easily accessible for cleaning.
- Load capacity of the shelf 25 kg.
- Load capacity of the drawer 25 kg.
- Load capacity of the cabinet 50 kg.

## Variants of implementation

- The sliding cabinet has a depth of 500 mm.

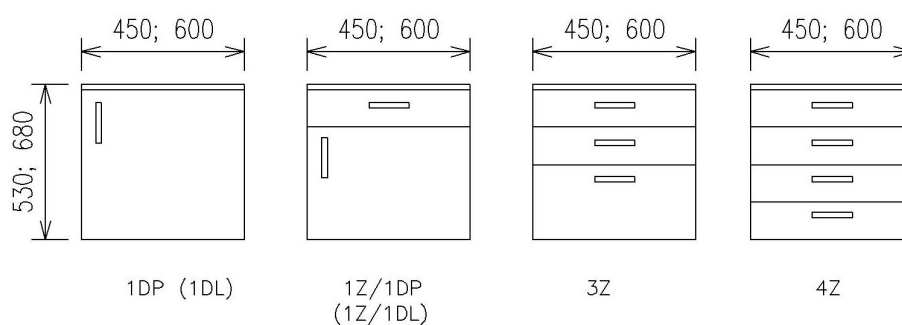

## Forlab - Bottom cabinets

# CABINET WITH HORIZONTAL SHIFT

**S1: Type designation**

210.05: Cabinet with horizontal shift

**S2: Material design**

value	material
A: Standard	The cabinet is made of molded laminated panels
B: Standard plus	Body is made of molded laminated panels, fronts are made of high pressure laminate of standard performance
C: Premium	Body and fronts are made of metal sheets with a chemically resistant coating

**S3: Cabinet width**

value	width
450: Cabinet width	450 mm
600: Cabinet width	600 mm

**S4: Cabinet height**

value	height
530: Cabinet height	530 mm
680: Cabinet height	680 mm

**S5: Cabinet design**

1DL: Cabinet with left-hand door  
 1DP: Cabinet with right door  
 1Z/1DL: One drawer, one left-hand door  
 1Z/1DP: One drawer, one right-hand door  
 3Z: Three drawer cabinet  
 4Z: Four drawer cabinet

**S6 : Cabinet lock - for extra charge**

N: Cabinet without lock  
 ZC: Central lock (for x drawers)  
 ZJ: Simple lock (for doors and drawers)

**S7: Handle**

U1: Standard handle circular with pitch of 128 mm  
 U2: Standard handle oval with pitch of 128 mm

**S8: Hardware**

KSS: Standard  
 KST: With damping and buffer - additional cost

Forlab - Bottom cabinets

## CABINET WITH HORIZONTAL SHIFT

### S9: Colour

BH001: The basic color for the material of the cabinets is STANDARD PLUS. Whole cabinet is in white colour.
BH002: The basic color for the material of the cabinets is STANDARD PLUS. Corpus white, gray fronts.
BH003: The basic color for the material of the cabinets is STANDARD PLUS. Corpus white, light blue fronts.
BH004: The basic color for the material of the cabinets is STANDARD PLUS. Corpus white, light green fronts.
BL001: The basic color for the material of the cabinets is STANDARD and PREMIUM . Whole cabinet is in white colour.
BL002: The basic color for the material of the cabinets is STANDARD and PREMIUM . Corpus white, gray fronts.
BL003: The basic color for the material of the cabinets is STANDARD and PREMIUM . Corpus white, blue fronts.
BL004: The basic color for the material of the cabinets is STANDARD and PREMIUM . Corpus white, green fronts.
BL005: The basic color for the material of the cabinets is STANDARD and PREMIUM . Corpus white, creamy-yellow fronts.
Bxxxx: Other than the basic colour of cabinets. The combination of colours in accordance with codes, see chapter Design.

### S10: Atypical - another solution in agreement with the trader

AT: Atypical finish - for extra charge
ST: Standard finish