

Forlab - Bottom cabinets

CORNER CABINETS

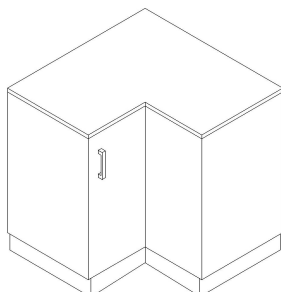

RH1

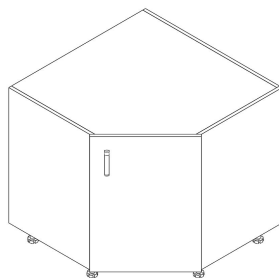

RH2

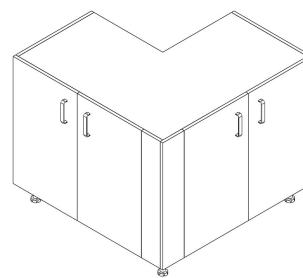

RH3

- Corner cabinets complement bottom cabinets (204.02) and sink cabinets (204.01).
- The advantage is the functional design of corner assemblies.
- In assemblies of tables can be created inside and outside corners.
- Load capacity of the shelf 30 kg.

Variants of implementation

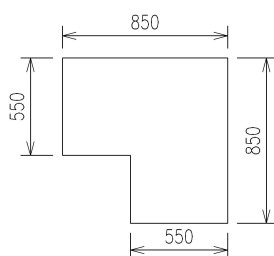

RH1
 Rectangular corner
 cabinet - inner corner

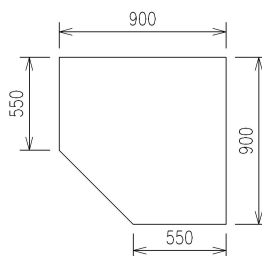

RH2
 Corner cabinet
 with angled corner

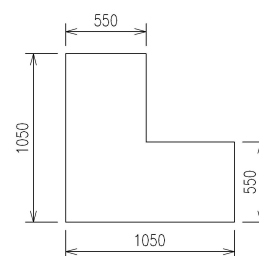

RH3
 Rectangular corner
 cabinet - outer corner

Forlab - Bottom cabinets

CORNER CABINETS

S1: Type designation

204.03: Corner cabinets for assemblies

S2: Material design

value	material
A: Standard	The cabinet is made of molded laminated panels
B: Standard plus	Body is made of molded laminated panels, fronts are made of high pressure laminate of standard performance
C: Premium	Body and fronts are made of metal sheets with a chemically resistant coating

S3: Cabinet height

value	height
720: Height of cabinet for seated operator	720 mm
870: Height of cabinet for standing operator	870 mm

S4: Cabinet design

RH3: Rectangular corner cabinet - Outer corner
 1DLRH1: Rectangular corner cabinet with left-hand opening
 1DLRH2: Angled corner cabinet with left-hand opening
 1DPRH1: Rectangular corner cabinet with right-hand opening
 1DPRH2: Angled corner cabinet with right-hand opening

S5: Visible cabinet side

N: Sides of the cabinets are not visible
 PL: Left-hand side of the cabinet is visible
 PP: Right-hand side of the cabinet is visible
 PV: Right-hand and left-hand side of the cabinet is visible

S6: Cabinet lock - for extra charge

N: Cabinet without lock
 ZJ: Simple lock (for doors)

S7: Transition between cabinet and floor

BAS: The cabinet is formed on the basic profile. Height 50 mm.
 SOK: The cabinet is formed on the basic legs and fitted with plinth. The height of 100 mm.
 01NH: Basic leg with plinth. The height of 100 mm.
 02NH: Basic plastic front leg. The height of 100 mm.
 03NH: Basic aluminum leg. The height of 100 mm.

S8: Handle

U1: Standard handle circular with pitch of 128 mm
 U2: Standard handle oval with pitch of 128 mm

Forlab - Bottom cabinets

CORNER CABINETS

S9: Hardware

KSS: Standard

KST: With damping - additional cost

S10: Colour

BH001: The basic color for the material of the cabinets is STANDARD PLUS. Whole cabinet is in white colour.

BH002: The basic color for the material of the cabinets is STANDARD PLUS. Corpus white, gray fronts.

BH003: The basic color for the material of the cabinets is STANDARD PLUS. Corpus white, light blue fronts.

BH004: The basic color for the material of the cabinets is STANDARD PLUS. Corpus white, light green fronts.

BL001: The basic color for the material of the cabinets is STANDARD and PREMIUM . Whole cabinet is in white colour.

BL002: The basic color for the material of the cabinets is STANDARD and PREMIUM . Corpus white, gray fronts.

BL003: The basic color for the material of the cabinets is STANDARD and PREMIUM . Corpus white, blue fronts.

BL004: The basic color for the material of the cabinets is STANDARD and PREMIUM . Corpus white, green fronts.

BL005: The basic color for the material of the cabinets is STANDARD and PREMIUM . Corpus white, creamy-yellow fronts.

Bxxxx: Other than the basic colour of cabinets. The combination of colours in accordance with codes, see chapter Design.

S11: Atypical - another solution in agreement with the trader

AT: Atypical finish - for extra charge

ST: Standard finish