

Forlab - Bottom cabinets

## SINK CABINETS

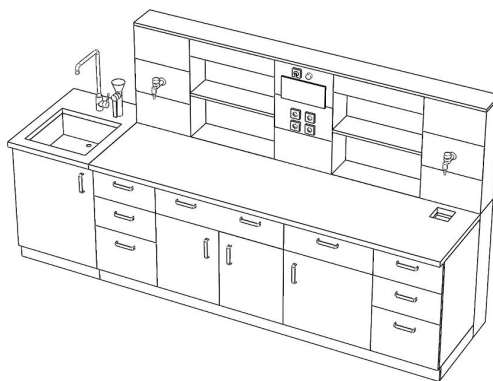
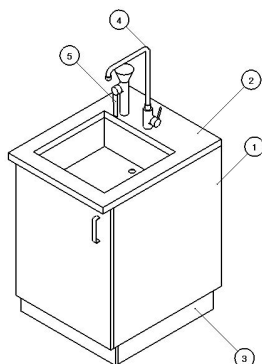

- 1 - Sink cabinet, chapter 204.01  
2 - Worktop, chapter 205.01  
3 - Covering to the floor, chapter 204.04  
4 - Mixers, chapter 207.02  
5 - Safety shower, chapter 207.04

- A sink cabinet may be a stand-alone laboratory element, or it may complement work table assemblies or laboratory table assemblies. That is why our offer of sink cabinets is so variable.

Dimension series:

Width (mm)

600; 900

Depth (mm)

600; 750; 900; 1350; 1500; 1650

Height (mm)

900

Forlab - Bottom cabinets

## SINK CABINETS

### Variants of implementation

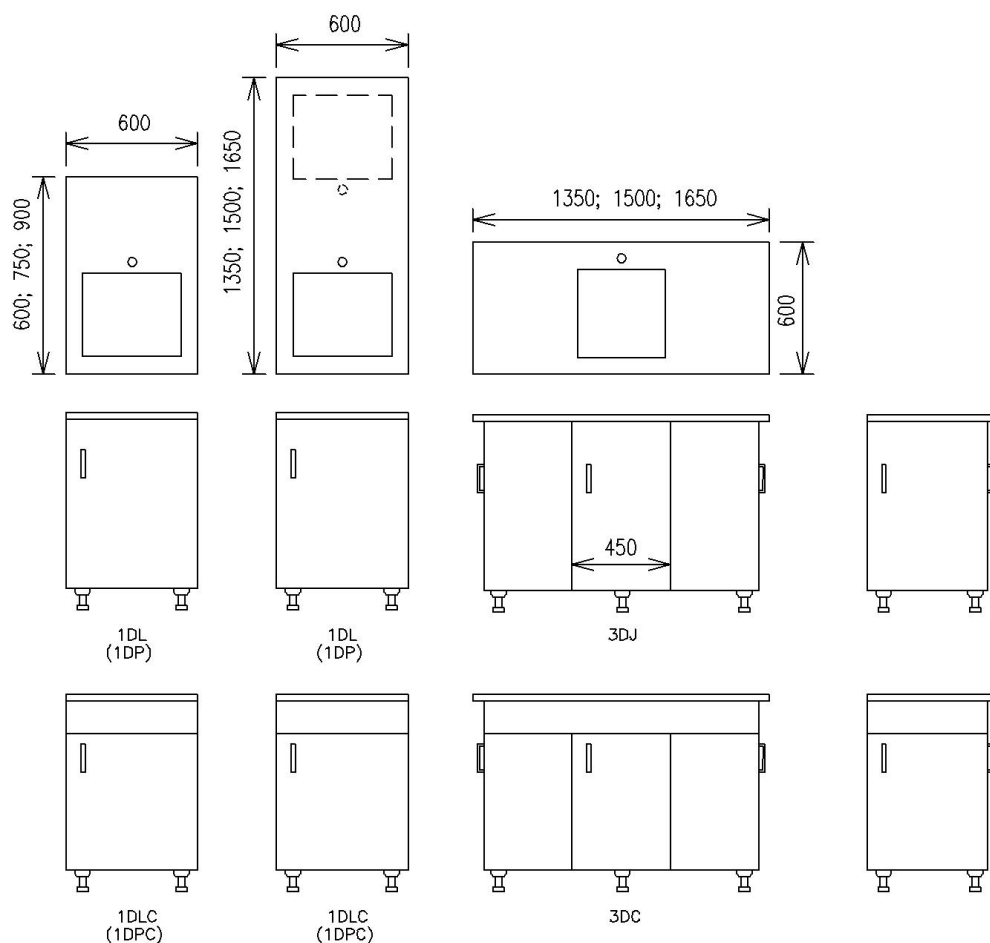

Forlab - Bottom cabinets

## SINK CABINETS

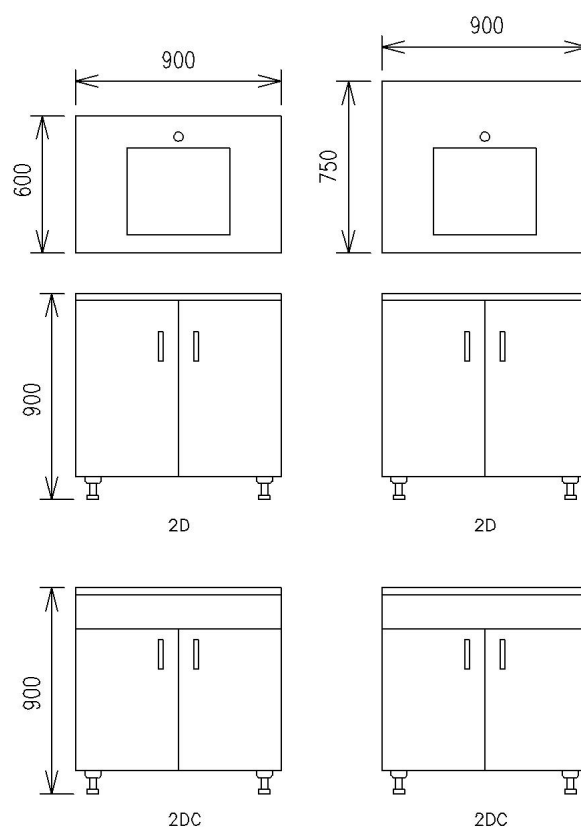

## Forlab - Bottom cabinets

# SINK CABINETS

## S1: Type designation

204.01: Sink cabinets

## S2: Material design

value	material
A: Standard	The cabinet is made of molded laminated panels
B: Standard plus	Body is made of molded laminated panels, fronts are made of high pressure laminate of standard performance
C: Premium	Body and fronts are made of metal sheets with a chemically resistant coating

## S3: Cabinet width

value	width
600: Sink cabinet width	600 mm
900: Sink cabinet width	900 mm

## S4: Worktop depth

value	depth
0600: Worktop depth	600 mm
0750: Worktop depth	750 mm
0900: Worktop depth	900 mm
1350: Worktop depth	1350 mm
1500: Worktop depth	1500 mm
1650: Worktop depth	1650 mm

## S5: Cabinet design

1DL: Sink cabinet with left-hand door opening. Cabinet width 600 mm.

1DLC: Sink cabinet with false face and left-hand door opening. Cabinet width 600 mm.

1DP: Sink cabinet with right-hand door opening. Cabinet width 600 mm.

1DPC: Sink cabinet with false face and right-hand door opening. Cabinet width 600 mm.

2D: Sink cabinet with double wing door. Cabinet width 900 mm.

2DC: Sink cabinet with double wing door and false face. Cabinet width 900 mm.

3DC: Sink cabinet with false face. Cabinet depth 600 mm.

3DJ: Sink cabinet depth 600 mm.

## S6: Transition between cabinet and floor

BAS: The cabinet is formed on the basic profile. Height 50 mm.

SOK: The cabinet is formed on the basic legs and fitted with plinth. The height of 100 mm.

01NH: Basic leg with plinth. The height of 100 mm.

02NH: Basic plastic front leg. The height of 100 mm.

03NH: Basic aluminum leg. The height of 100 mm.

## S7: Handle

U1: Standard handle circular with pitch of 128 mm

U2: Standard handle oval with pitch of 128 mm

Forlab - Bottom cabinets

## SINK CABINETS

### S8: Hardware

KSS: Standard

KST: With damping - additional cost

### S9: Colour

BH001: The basic color for the material of the cabinets is STANDARD PLUS. Whole cabinet is in white colour.

BH002: The basic color for the material of the cabinets is STANDARD PLUS. Corpus white, gray fronts.

BH003: The basic color for the material of the cabinets is STANDARD PLUS. Corpus white, light blue fronts.

BH004: The basic color for the material of the cabinets is STANDARD PLUS. Corpus white, light green fronts.

BL001: The basic color for the material of the cabinets is STANDARD and PREMIUM . Whole cabinet is in white colour.

BL002: The basic color for the material of the cabinets is STANDARD and PREMIUM . Corpus white, gray fronts.

BL003: The basic color for the material of the cabinets is STANDARD and PREMIUM . Corpus white, blue fronts.

BL004: The basic color for the material of the cabinets is STANDARD and PREMIUM . Corpus white, green fronts.

BL005: The basic color for the material of the cabinets is STANDARD and PREMIUM . Corpus white, creamy-yellow fronts.

Bxxxx: Other than the basic colour of cabinets. The combination of colours in accordance with codes, see chapter Design.

### S10: Atypical - another solution in agreement with the trader

AT: Atypical finish - for extra charge

ST: Standard finish