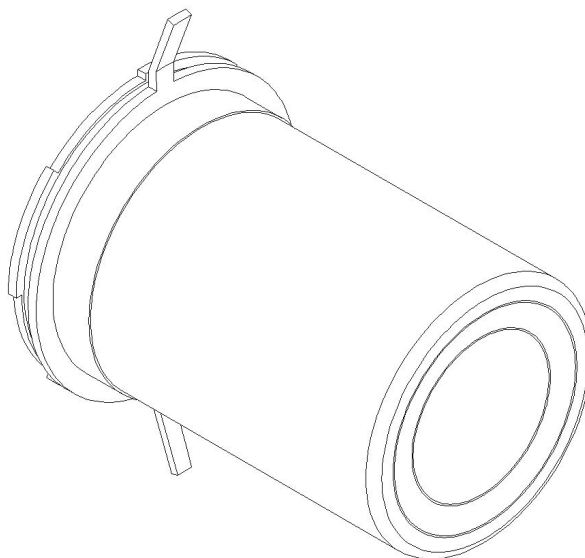

Equipment and Isolator technology - Isolator workplace

BETA PORT - RTP (RAPID TRANSFER PORT)

RTP (Rapid Transfer Port) is a device used to safe transfer material from the chamber to another location, while preventing contamination of the product or the environment. RTP consists of two basic parts. The Alpha port is fixed on the isolator chamber; the Beta port, which is connected to the Alpha port, is used as a container for material transfer. RTP is based on a double-door principle; the port into the container may not be opened until the Alpha and Beta ports are connected. RTP is often used for material output and transport or for the removal of solid waste from the chambers. The system is available in four standard sizes: 105, 190, 270 and 350 mm. Beta ports are available in two material versions: PE and stainless steel. The materials are resistant to multiple sterilization (autoclave, ethylene oxide, gamma sterilization, H₂O₂ sterilization, etc.).

The RTP system features the following safety systems to protect against accidental detachment:

- The Alpha door cannot be opened if the Beta container is incorrectly connected or placed.
- When the Alpha door is opened, the Beta container cannot be disconnected.

Equipment and Isolator technology - Isolator workplace

BETA PORT - RTP (RAPID TRANSFER PORT)**S1: Port type designation**

510.54: port type designation

S2: Selection of dimension range and material design

AISI105/400: dimension range 105, length 400, stainless steel design

AISI190/400: dimension range 190, length 400, stainless steel design

AISI270/400: dimension range 270, length 400, stainless steel design

AISI350/500: dimension range 350, length 500, stainless steel design

PE190/400: dimension range 190, length 400, polyethylene design

PE270/400: dimension range 270, length 400, polyethylene design

PE270/500: dimension range 270, length 500, polyethylene design

PE350/500: dimension range 350, length 500, polyethylene design

In this category, you can select the size of the Beta containers and their material design.

S3: Accesories

C: Protective seal cover, only stainless steel version

K: Key to open the Beta port without using the Alpha port

In this category, you can select optional accessories for the ports concerned.