

Forlab - Bottom cabinets

SINK CABINETS

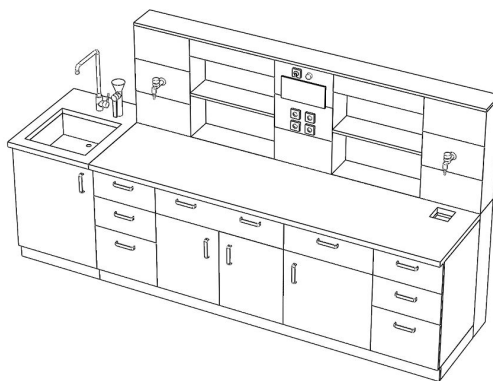
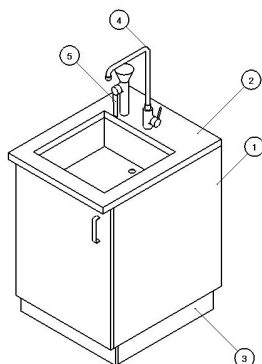

- 1 - Sink cabinet, chapter 204.01
2 - Worktop, chapter 205.01
3 - Covering to the floor, chapter 204.04
4 - Mixers, chapter 207.02
5 - Safety shower, chapter 207.04

- A sink cabinet may be a stand-alone laboratory element, or it may complement work table assemblies or laboratory table assemblies. That is why our offer of sink cabinets is so variable.

Dimension series:

| | |
|-------------|---------------------------|
| Width (mm) | 600; 900 |
| Depth (mm) | 600; 750; 800; 1500; 1600 |
| Height (mm) | 900 |

Forlab - Bottom cabinets

SINK CABINETS

Variants of implementation

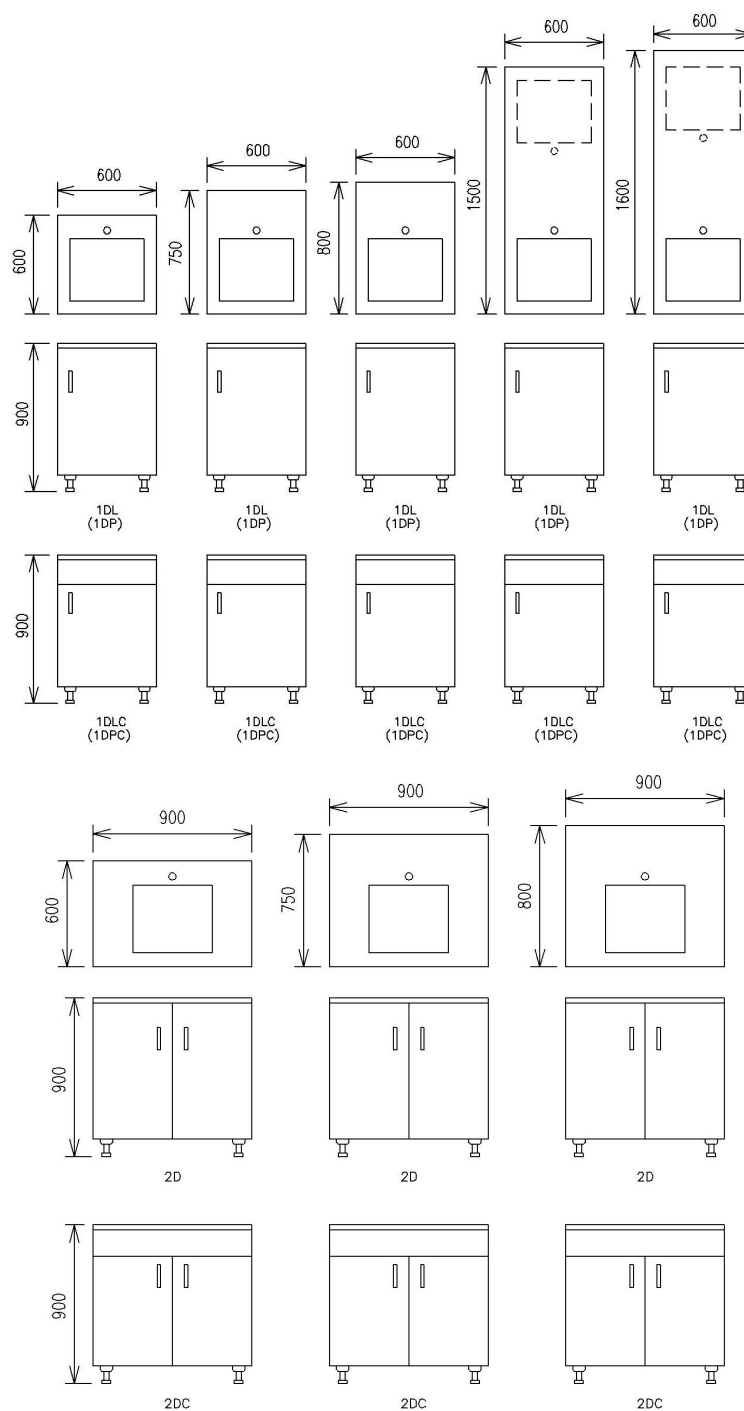

Forlab - Bottom cabinets

SINK CABINETS

S1: Type designation

204.01: Sink cabinets

S2: Material design

| value | material |
|------------------|--|
| A: Standard | The cabinet is made of molded laminated panels |
| B: Standard plus | Body is made of molded laminated panels, fronts are made of high pressure laminate of standard performance |
| C: Premium | Body and fronts are made of metal sheets with a chemically resistant coating |

S3: Cabinet width

| value | width |
|-------------------------|--------|
| 600: Sink cabinet width | 600 mm |
| 900: Sink cabinet width | 900 mm |

S4: Worktop depth

| value | depth |
|---------------------|---------|
| 0600: Worktop depth | 600 mm |
| 0750: Worktop depth | 750 mm |
| 0800: Worktop depth | 800 mm |
| 1500: Worktop depth | 1500 mm |
| 1600: Worktop depth | 1600 mm |

S5: Cabinet design

1DL: Sink cabinet with left-hand door opening.

1DLC: Sink cabinet with false face and left-hand door opening.

1DP: Sink cabinet with right-hand door opening.

1DPC: Sink cabinet with false face and right-hand door opening.

2D: Double wing door. Cabinet width 900 mm.

2DC: Cabinet with double wing door and false face. Cabinet width 900 mm.

S6: Transition between cabinet and floor

BAS: The cabinet is formed on the basic profile. Height 50 mm.

SOK: The cabinet is formed on the basic legs and fitted with plinth. The height of 100 mm.

01NH: Basic leg with plinth. The height of 100 mm.

02NH: Basic plastic front leg. The height of 100 mm.

03NH: Basic aluminum leg. The height of 100 mm.

04NH: Aluminum leg - for extra charge. The height of 100 mm.

05NH: Plastic leg - for extra charge. The height of 100 mm.

S7: Handle

U1: Standard handle circular with pitch of 128 mm.

U2: Standard handle oval with pitch of 128 mm.

U3: Standard handle oval with pitch of 160 mm.

Forlab - Bottom cabinets

SINK CABINETS

S8: Hardware

KSS: Standard

KST: With damping - additional cost

S9: Colour

BH001: The basic color for the material of the cabinets is STANDARD PLUS. Whole cabinet is in white colour.

BH002: The basic color for the material of the cabinets is STANDARD PLUS. Corpus white, gray fronts.

BH003: The basic color for the material of the cabinets is STANDARD PLUS. Corpus white, light blue fronts.

BH004: The basic color for the material of the cabinets is STANDARD PLUS. Corpus white, light green fronts.

BL001: The basic color for the material of the cabinets is STANDARD and PREMIUM . Whole cabinet is in white colour.

BL002: The basic color for the material of the cabinets is STANDARD and PREMIUM . Corpus white, gray fronts.

BL003: The basic color for the material of the cabinets is STANDARD and PREMIUM . Corpus white, blue fronts.

BL004: The basic color for the material of the cabinets is STANDARD and PREMIUM . Corpus white, green fronts.

BL005: The basic color for the material of the cabinets is STANDARD and PREMIUM . Corpus white, creamy-yellow fronts.

Bxxxx: Other than the basic colour of cabinets. The combination of colours in accordance with codes, see chapter Design.

S10: Atypical - another solution in agreement with the trader

AT: Atypical finish - for extra charge

ST: Standard finish