

Forlab - Bottom cabinets

CORNER CABINETS

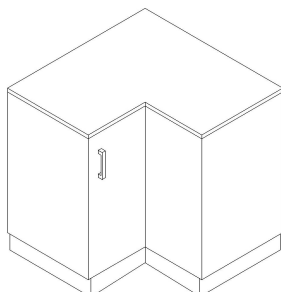

RH1

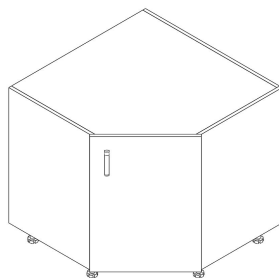

RH2

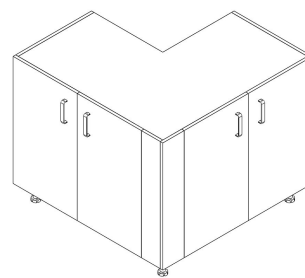

RH3

- Corner cabinets complement bottom cabinets (204.02) and sink cabinets (204.01).
- The advantage is the functional design of corner assemblies.
- In assemblies of tables can be created inside and outside corners.

Variants of implementation

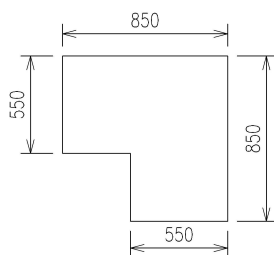

RH1
 Rectangular corner
 cabinet - inner corner

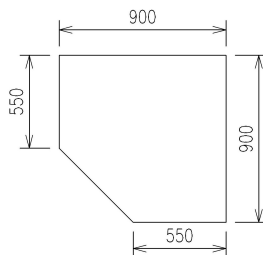

RH2
 Corner cabinet
 with angled corner

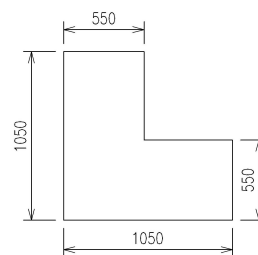

RH3
 Rectangular corner
 cabinet - outer corner

Forlab - Bottom cabinets

CORNER CABINETS

S1: Type designation

204.03: Corner cabinets for assemblies

S2: Material design

value	material
A: Standard	The cabinet is made of molded laminated panels
B: Standard plus	Body is made of molded laminated panels, fronts are made of high pressure laminate of standard performance
C: Premium	Body and fronts are made of metal sheets with a chemically resistant coating

S3: Cabinet height

value	height
720: Height of cabinet for seated operator	720 mm
870: Height of cabinet for standing operator	870 mm

S4: Cabinet design

RH3: Rectangular corner cabinet - Outer corner

1DLRH1: Rectangular corner cabinet with left-hand opening.

1DLRH2: Angled corner cabinet with left-hand opening.

1DPRH1: Rectangular corner cabinet with right-hand opening.

1DPRH2: Angled corner cabinet with right-hand opening.

S5: Transition between cabinet and floor

BAS: The cabinet is formed on the basic profile. Height 50 mm.

SOK: The cabinet is formed on the basic legs and fitted with plinth. The height of 100 mm.

01NH: Basic leg with plinth. The height of 100 mm.

02NH: Basic plastic front leg. The height of 100 mm.

03NH: Basic aluminum leg. The height of 100 mm.

S6: Handle

U1: Standard handle circular with pitch of 128 mm.

U2: Standard handle oval with pitch of 128 mm.

S7: Hardware

KSS: Standard

KST: With damping - additional cost

Forlab - Bottom cabinets

CORNER CABINETS

S8: Colour

BH001: The basic color for the material of the cabinets is STANDARD PLUS. Whole cabinet is in white colour.
BH002: The basic color for the material of the cabinets is STANDARD PLUS. Corpus white, gray fronts.
BH003: The basic color for the material of the cabinets is STANDARD PLUS. Corpus white, light blue fronts.
BH004: The basic color for the material of the cabinets is STANDARD PLUS. Corpus white, light green fronts.
BL001: The basic color for the material of the cabinets is STANDARD and PREMIUM . Whole cabinet is in white colour.
BL002: The basic color for the material of the cabinets is STANDARD and PREMIUM . Corpus white, gray fronts.
BL003: The basic color for the material of the cabinets is STANDARD and PREMIUM . Corpus white, blue fronts.
BL004: The basic color for the material of the cabinets is STANDARD and PREMIUM . Corpus white, green fronts.
BL005: The basic color for the material of the cabinets is STANDARD and PREMIUM . Corpus white, creamy-yellow fronts.
Bxxxx: Other than the basic colour of cabinets. The combination of colours in accordance with codes, see chapter Design.

S9: Atypical - another solution in agreement with the trader

AT: Atypical finish - for extra charge
ST: Standard finish